

DO NOT SCALE

Millimetres

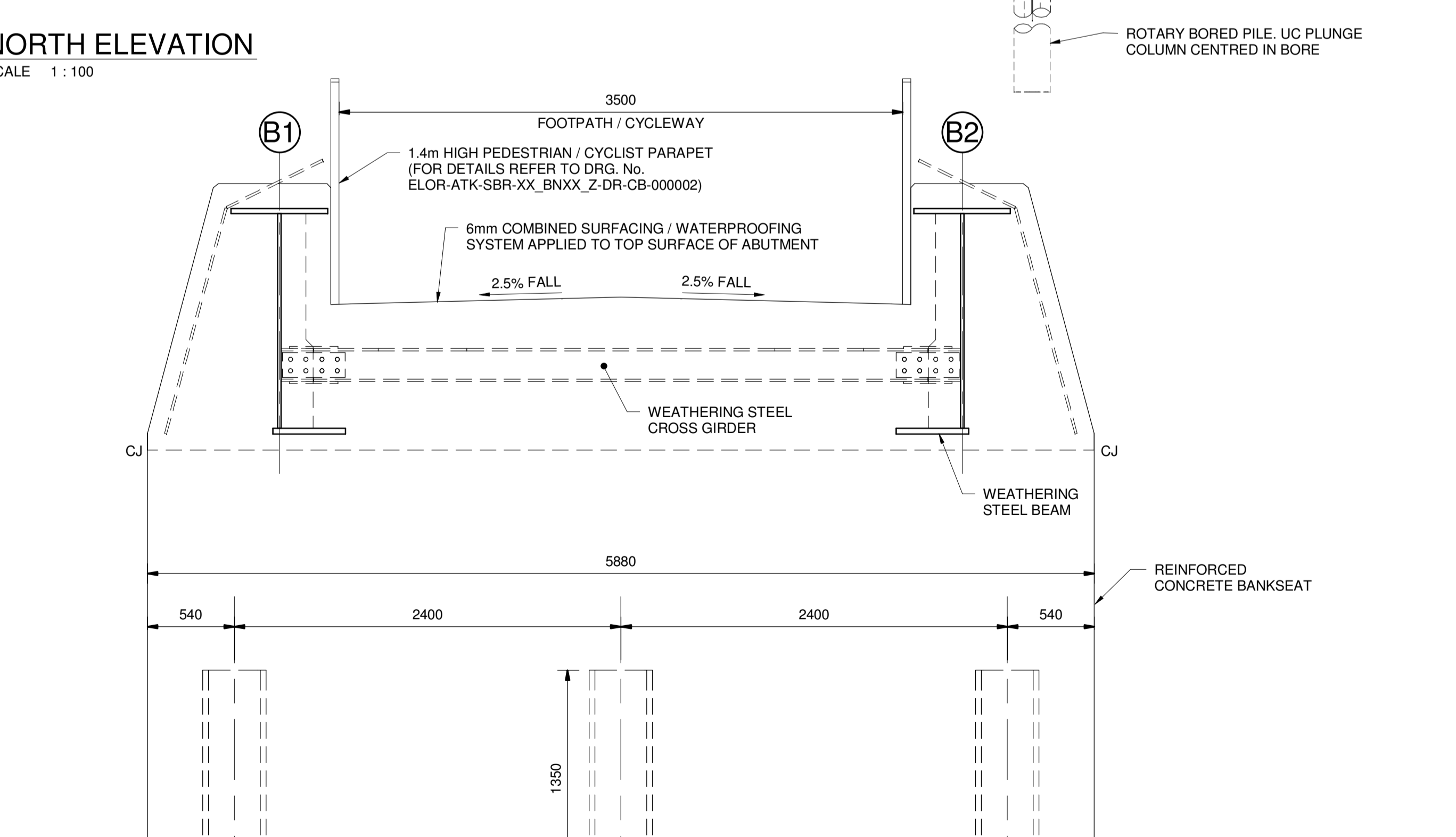

- NOTES:
- THIS DRAWING SHALL BE READ IN CONJUNCTION WITH ALL OTHER RELEVANT DRAWINGS INCLUDING THOSE LISTED ON ELOR-ATK-SBR-L5_BN04_Z-DR-CB-170020.
 - ALL LEVELS IN METRES UNLESS OTHERWISE NOTED.
 - ALL DIMENSIONS ARE IN MILLIMETRES UNLESS OTHERWISE NOTED.

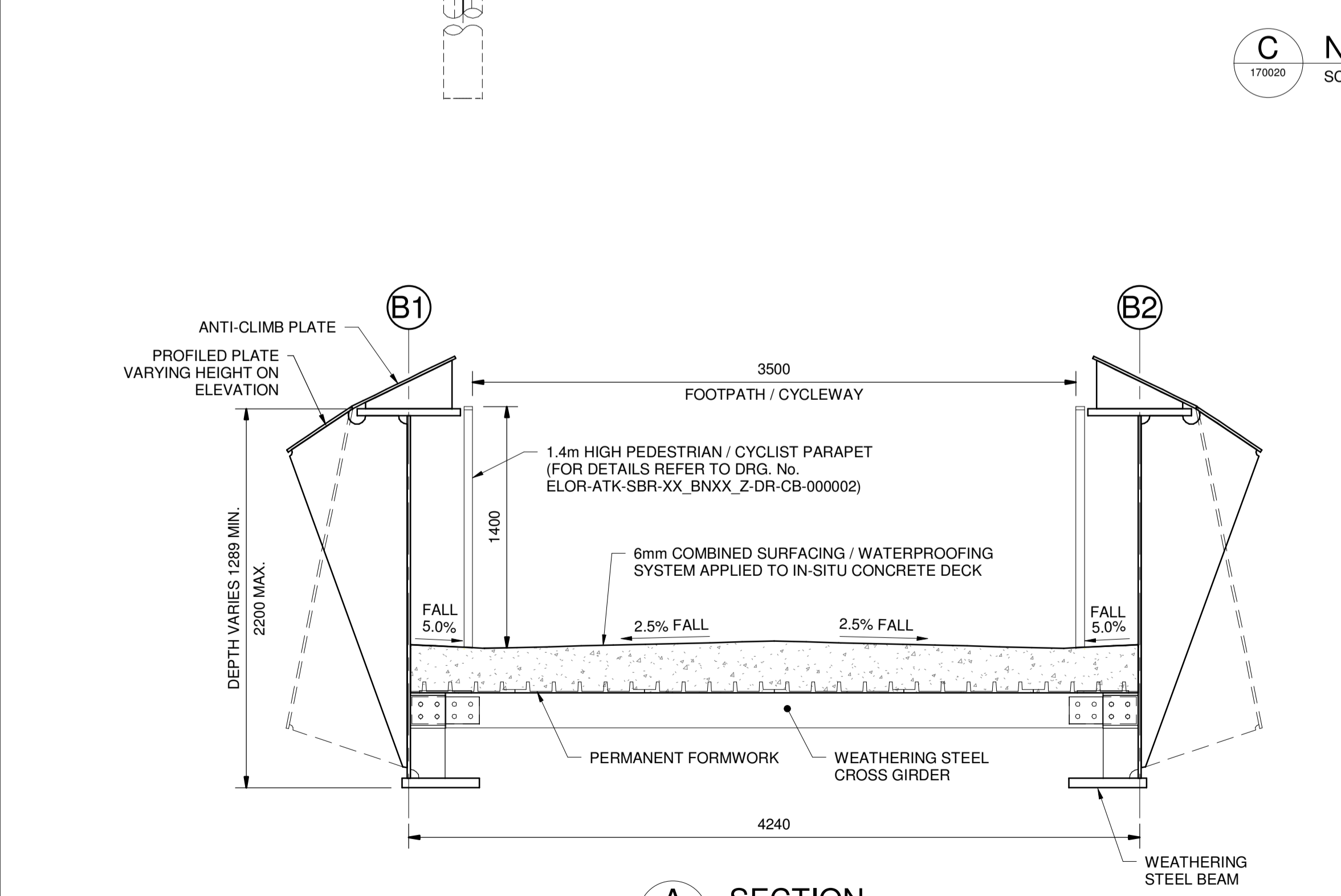
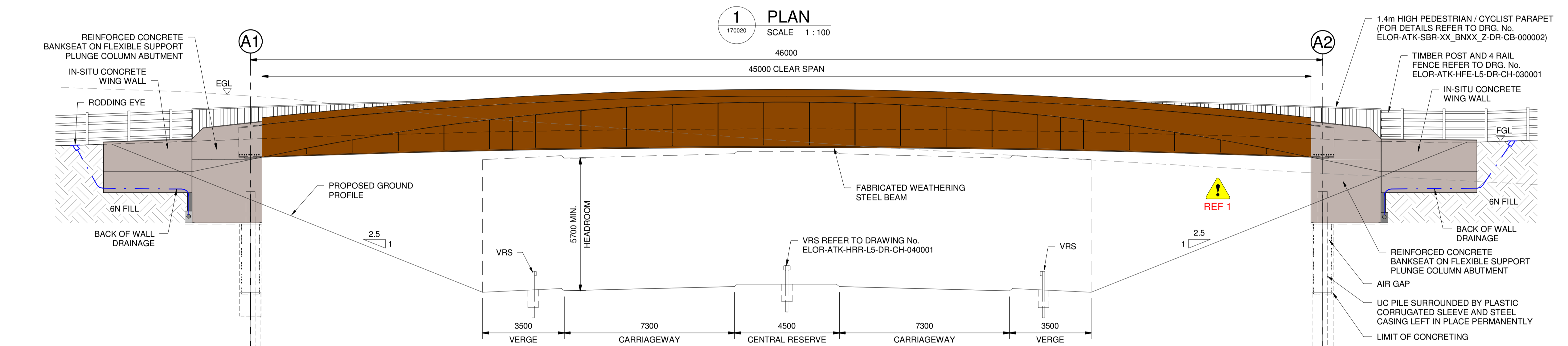
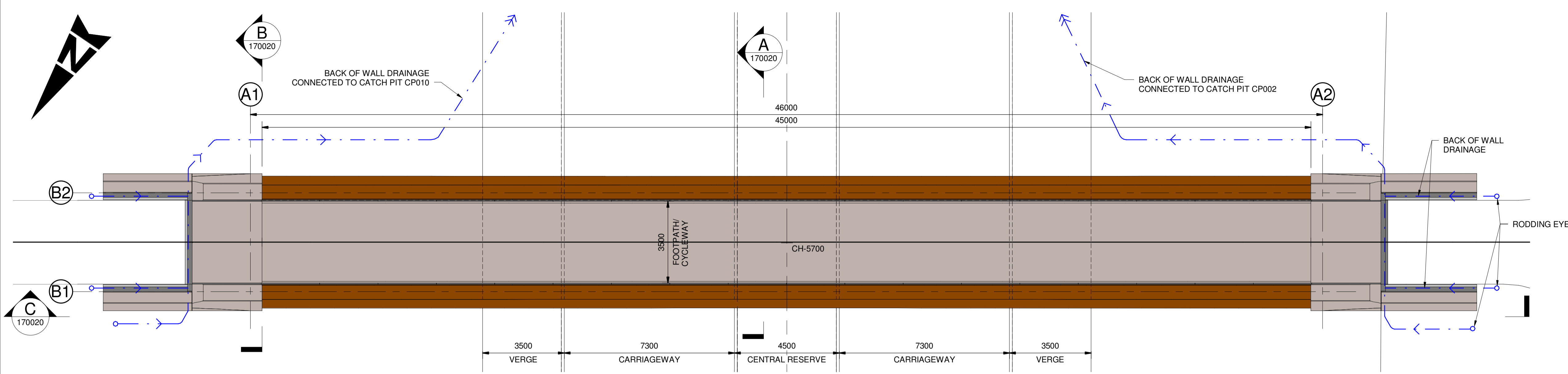
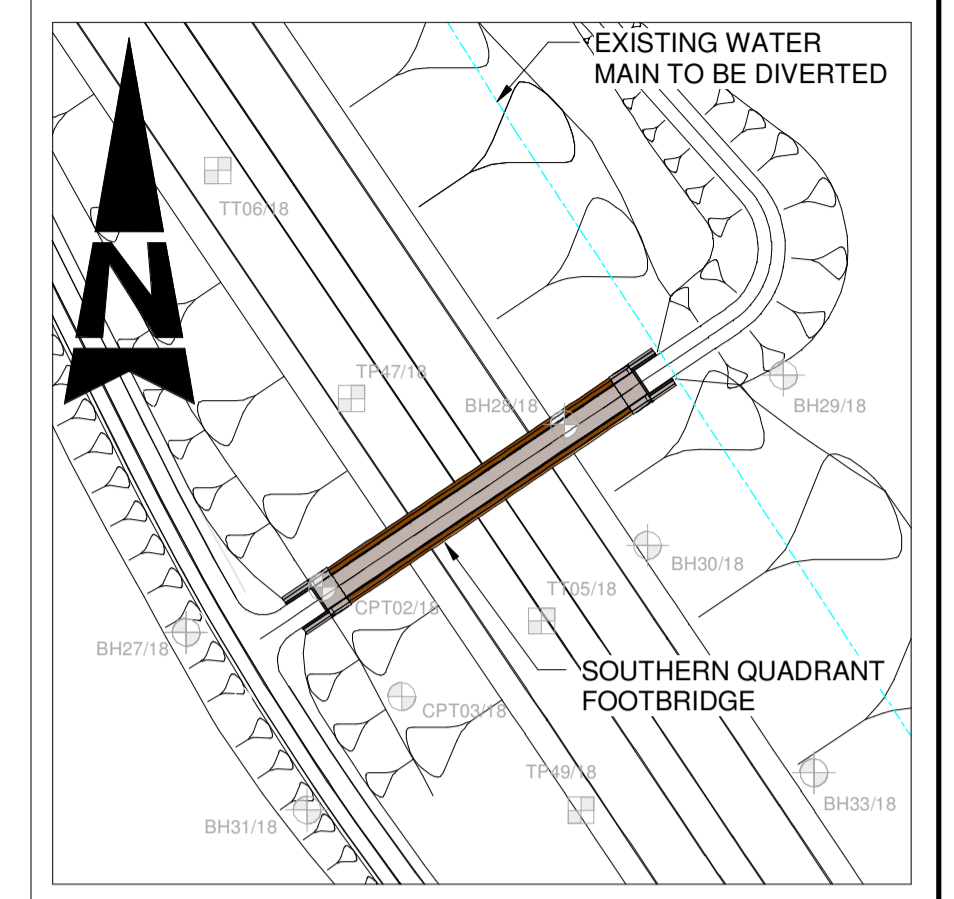

SAFETY, HEALTH AND ENVIRONMENTAL INFORMATION

In addition to the hazards/risks normally associated with the types of work detailed on this drawing, note the following:

CONSTRUCTION

REF 1. GIRDERS ARE SUSCEPTIBLE TO LATERAL TORSIONAL BUCKLING WHEN NOT PAIRED WITH EACH OTHER.

MAINTENANCE/CLEANING

NONE

DECOMMISSIONING/DEMOLITION

NONE

It is assumed that all works will be carried out by a competent contractor working, where appropriate, to an approved method statement

Rev.	Date	Description	By	Chk'd	App'd
C01	26/06/2020	ISSUED FOR CONSTRUCTION	JN	ED	DA

Drawing Suitability: APPROVED & ACCEPTED - CONSTRUCTION Status: A3

ATKINS
Member of the SNC-Lavalin Group

3100 Thorpe Park
Century Way
Leeds
West Yorkshire
LS15 8ZB

Tel: +44 (0)1133 066000
Fax: +44 (0)1133 066001
www.atkinsglobal.com

Copyright © Atkins Limited (2019)

Client: **Leeds City Council** **Balfour Beatty**

Project Title: EAST LEEDS ORBITAL ROUTE

Drawing Title: SOUTHERN QUADRANT FOOTBRIDGE GENERAL ARRANGEMENT

Drawing Number: ELOR-ATK-SBR-L5_BN04_Z-DR-CB-170020

Original Size	Scale	Project Ref. No.	Location	Type	Role	Number
A1	AS Indicated	ELOR	Leeds	Footbridge	Author	1 of 1

Rev: C01

